

SHUTDOWN PRESSOSTATS

B



USE

- Shutdown and safety pressure controls with manual reset, suitable for fluids and inert gases in general.
- In compliance with the standards of the R.3.B. technical specifications of the D.M. dated December 1st, 1975
- For use in connection with a regulation pressostat.

INSTALLATION AND OPERATION

- Stainless steel sensing element membrane.
- Internal regulation: the cover is made to be welded after setting and testing.
- Female G 1/4" connection (17mm. key).

TECHNICAL FEATURES

- Elements in contact with the fluid are made in stainless steel.
- Base, cover and knob in V0 self-extinguishing, antishock thermoplastic material.
- PVC grommet for cable entry.

HOMOLOGATION AND STANDARDS

- Complies with CEI EN60947-5-1 standards
- B01BM with I.S.P.E.S.L. homologation

ELECTRICAL FEATURES

- Snap action SPDT microswitch, with manual reset; contacts in silver alloy.
- When pressure rises: 1-2 opens

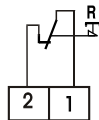

Nominal insulation	Ui	380V~
Continuous duty nominal current	Ith	15A
Operating nominal current Ie:		220V- 250V~ 380V~
Resistive load	AC-12	- 10A 10A
Inductive load	AC-15	- 2.5A 1.5A
Continuous nominal current	DC-13	0.2A - -

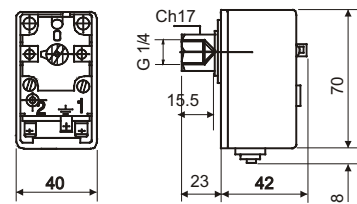

TYPE	RANGE bar	Max. sensitive element pressure bar	Max. fluid temperature °C	Maximum pressostat body temperature °C	Protection	Weight each Kg	Box pcs. No
B01AM	0,7 to 3	6	120	-35 to 80	IP 40	0.14	
B01BM	2 to 5,5	7	120	-35 to 80	IP 40	0.14	
B01CM	3 to 7	9	120	-35 to 80	IP 40	0.14	
B01DM	4 to 15	18	120	-35 to 80	IP 40	0.14	

- ◆ In the case of fluid temperatures higher than the maximum allowed, connect a metallic spiral between the pressure switch and the pipe to facilitate heat dispersion.
- **N.B.** Transport and storage temperatures are equivalent to the max. allowable pressostat body temperature.

1bar = 100KPa

ACCESSORIES

-G 1/2 cable gland in V0 self-extinguishing, antishock, thermoplastic material.....code**303298L**

SPECIAL EXECUTIONS (for large quantities, ask for offer)

-Male G 1/4"connection..... **B01....4**